

## Camp de Mar

Reference 120964



  
PORTA MALLORQUINA®  
Your home. Our passion.

End-of-terrace house in a well-maintained complex in Camp de Mar – perfect for golf lovers

constructed area:	311 m <sup>2</sup>	energy certificate:	d
plot area:	173 m <sup>2</sup>		
bedrooms:	3		
bathrooms:	2		
sea view:	-	<b>price:</b>	<b>€ 995,000.-</b>



## Camp de Mar

### Reference 120964



### Details:

This beautiful property is located in a quiet and well-maintained golf complex in Camp de Mar. The well-known beach is in the immediate vicinity and offers small shops as well as a selection of good restaurants directly by the sea.

The highlight of the house is the generous terrace area of approx. 103 sqm, distributed across different levels and offering plenty of space for peace and relaxation. From here, you can enjoy a beautiful view of the lush green golf course and the surrounding mountains.

The end-of-terrace house offers a constructed interior area of approx. 208 sqm and a well-designed layout. It features 3 bedrooms and 2 bathrooms, one of them en suite. From the bedrooms, there is direct access to the garden. The open and spacious living and dining area with fireplace creates a pleasant living atmosphere. The open, fully equipped kitchen is harmoniously integrated into the living area. From here, you have direct access to the terrace with views of the golf course.

Further features include a carport, underfloor heating, garden, guest toilet, utility room, cable/satellite TV, fireplace, built-in wardrobes, storage/cellar room, alarm system, intercom system, electric entrance gate and communal pool.

A well-maintained property in a beautiful golf setting, ideal for those who wish to combine peace, nature and proximity to the beach of Camp de Mar.

## Camp de Mar

Reference 120964



### Location & surrounding area:

Camp de Mar has developed to a luxury holiday destination by its famous owner of vacational houses. The famous 18 holes golf course is another attraction. The location of Camp de Mar in reference to Palma and the airport can be seen as ideal. The city life of Palma is arriveable in only 30 minutes by car. Nowadays there are some glamorous restaurants and shops nearby the delightful bay that is surrounded by rocks.

# Camp de Mar

Reference 120964



Balcony



Garden



Living area



Dining area



Bedroom



Bathroom

All information is correct to the best of our knowledge. Errors and prior sale excepted. This prospectus is purely for information purposes. Only the notarized deed of sale is legally binding.

# Camp de Mar

## Reference 120964



Terrace



Kitchen



Terrace



Bedroom



Bathroom



Terrace

All information is correct to the best of our knowledge. Errors and prior sale excepted. This prospectus is purely for information purposes. Only the notarized deed of sale is legally binding.

# Camp de Mar

Reference 120964



Pool

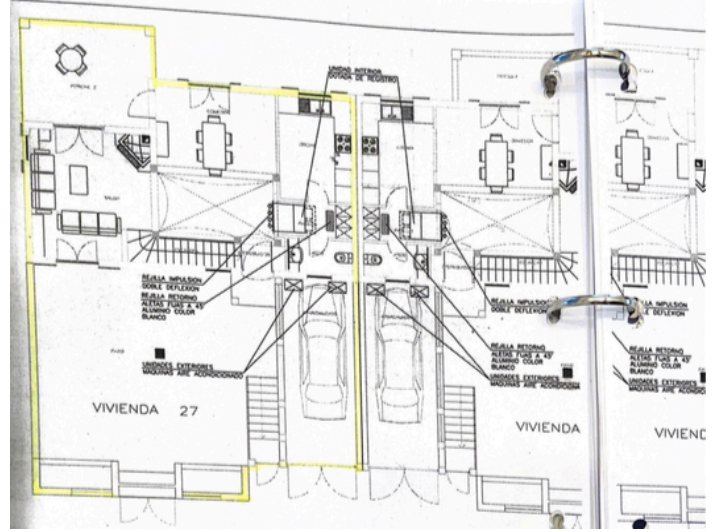

Plan

All information is correct to the best of our knowledge. Errors and prior sale excepted. This prospectus is purely for information purposes. Only the notarized deed of sale is legally binding.

PORTA MALLORQUINA • THERESIENSTR.: 81, 80333 MUNICH  
TEL. +34 971 698 242 • INFO@PORTAMALLORQUINA.COM