

## Son Espanyolet

Reference 116533C



  
**PORTA MALLORQUINA®**  
Your home. Our passion.

Spectacular and luxurious new construction with terraces and pool in a desirable area of Palma

constructed area: 73 m<sup>2</sup>  
bedrooms: 1  
bathrooms: 1  
balcony/terrace: ✓  
sea view: -

swimming pool: ✓  
energy certificate: in process

**price: € 559,000.-**

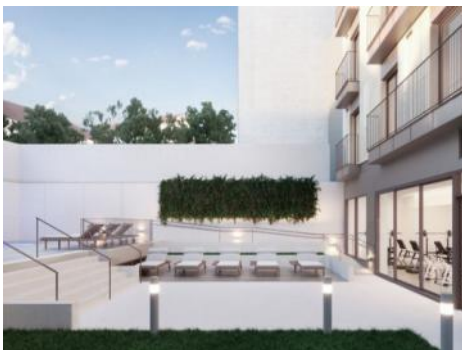

## Son Espanyolet

### Reference 116533C



### Details:

This unique project in an exclusive location between the Santa Catalina and Son Espanyolet districts will make your dreams come true. The 25 apartments offer a high level of living comfort thanks to their high-quality and elegant materials.

The communal areas are located on the first floor of the building. Different zones to relax in the sun, swimming pool, garden, a bright gym and 2 elevators. All this with a practical and luxurious design. In each apartment you can choose between 3 different interior layouts. This way you can further personalize your preferred style. For example, porcelain stoneware or hardwood floors, titanium or stainless steel fittings, white or dark kitchens.

This approx. 57 sqm apartment is located on the second floor and has a bedroom and a bathroom, a kitchen open to the living room with utility room and a terrace of approx. 5.2 sqm. A bright and very friendly apartment.

The building's underground garage extends over 2 floors and the price of a parking space is €39,900. The price of the storage rooms can be provided on request.

## Son Espanyolet

### Reference 116533C



### Location & surrounding area:

Son Espanyolet is a growing and charming area located right next to the trendy Santa Catalina district with the most diverse culinary offer of restaurants, bars and cafés that Palma has to offer. Despite its central location, Son Espanyolet is characterised by the quiet atmosphere you will find there. It is an ideal place to live away from the hustle and bustle of the big city, but still be surrounded by all kinds of amenities such as supermarkets, pharmacies, cafés, bars and restaurants. The Juaneda Private Hospital is also located in Son Espanyolet.

The famous Paseo Marítimo, the fantastic promenade that runs parallel to the coast of Palma and is ideal for walking, sports and enjoying restaurants and clubs, is also only a 7 minute walk away. With several schools nearby, this area is a popular choice for families. The area is a mixture of villas with gardens and low buildings. From many of the properties you can enjoy beautiful views of Bellver Castle, which is within walking distance and offers stunning views over the bay of Palma. Early risers can enjoy the sunrise over Palma here.



# Son Espanyolet

## Reference 116533C



Terrace, pool and gym area



Terrace



Living and dining area - Shine



Living and dining area - Light



Living and dining area - Glam



Kitchen

All information is correct to the best of our knowledge. Errors and prior sale excepted. This prospectus is purely for information purposes. Only the notarized deed of sale is legally binding.



# Son Espanyolet

## Reference 116533C



Bathroom - Light



Bathroom - Shine



Entrance area



Front view

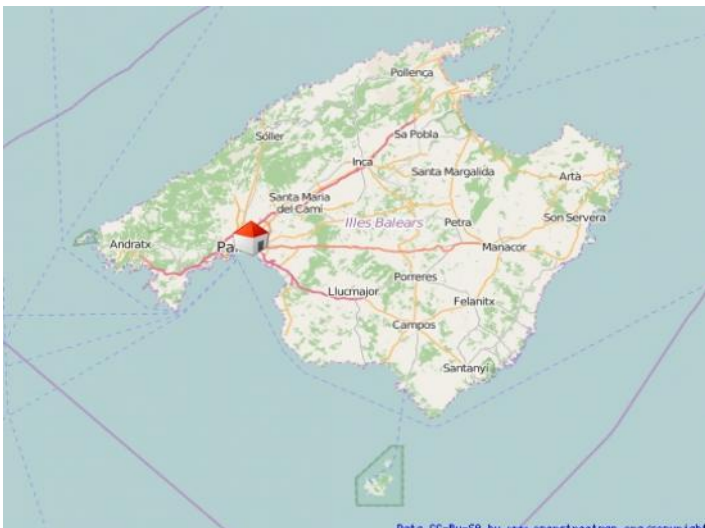

Palma

All information is correct to the best of our knowledge. Errors and prior sale excepted. This prospectus is purely for information purposes. Only the notarized deed of sale is legally binding.

PORTA MALLORQUINA • THERESIENSTR.: 81, 80333 MUNICH  
TEL. +34 971 698 242 • INFO@PORTAMALLORQUINA.COM