

Portixol
Reference 112913E



Exclusive, 2-bedroom designer-apartment with 2 terraces in Nou Llevant, Palma

constructed area:	158 m ²	swimming pool:	✓
bedrooms:	2	energy certificate:	in process
bathrooms:	2		
balcony/terrace:	✓		
sea view:	-	price:	€ 1,200,000.-



Portixol

Reference 112913E

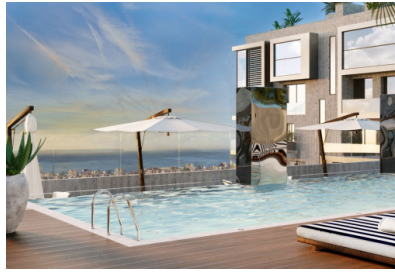

Details:

Luxurious 2-bedroom new-build apartment with high-end fittings and exceptional design.

The Residences offer comfort and service with excellent facilities and services, including a cafe, a private meeting room and various leisure / and communal areas such as the rooftop swimming pool, a modern gym, an elegant pavilion or the "Owners Lounge". Modern urban living is redefined here.

This luxurious new-build apartment has a total living area of around 118 square meters, spread over 2 bedrooms and 2 bathrooms, one en suite and a spacious living area with an open-plan kitchen and a utility room. Two spacious terraces with a total area of 40 sqm run around the corners and can be accessed from both bedrooms and the living area.

The residential complex is equipped with a high-tech security system, video surveillance and a 24-hour concierge service.

Sustainability is a top priority here. Energy class A is achieved through the use of rainwater, intelligent planting and façade greening, as well as the use of top-quality materials. This is the first multi-family building on the island to achieve this energy class.

A combination of the RAW and Vanity design lines adorns this luxurious dream home and ensures a comfortable and clear living ambience. Extras such as a concept for the entire interior design can also be ordered.

Parking spaces in the building's own underground garage can be purchased for €30,000, including an electric charging station if desired.

Portixol
Reference 112913E

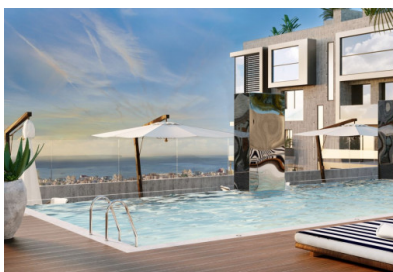

Location & surrounding area:

With unbeatable location just minutes from the beach (250 meters), Portixcol (200 meters), the old town and Puerto de Palma (500 meters), and the airport 10 minutes away.

Portixol
Reference 112913E

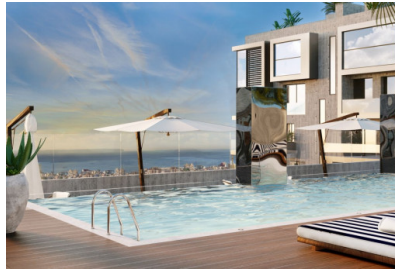

Light-flooded dining area and open kitchen



Extraordinary living area



Alternative design of the living room



Modern bathroom



Further bathroom



Community area with gym

All information is correct to the best of our knowledge. Errors and prior sale excepted. This prospectus is purely for information purposes. Only the notarized deed of sale is legally binding.